

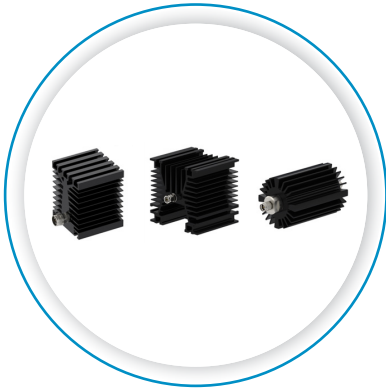

# MEDIUM & HIGH POWER ATTENUATORS

Outstanding Performance and Quality at a Competitive Price



Synergy released a new range of attenuators up to 6 GHz, from 30 to 150 W, available with Type N, SMA and TNC connections. This comprehensive offer ensures outstanding performance and quality at a competitive price.

- Medium and high power attenuators from 30 to 150 W, up to 6 GHz:
- Available with 3 types of connections: Type N, SMA and TNC (male and female interfaces)
  - Custom design available upon request
  - Range of attenuation from 3 to 30 dB

Electrical Performance / Requirements:

- Frequency range: DC-6 GHz
- VSWR max: 1.25 @ 6 GHz
- Peak power: 2 kW
- Impedance: 50 Ohms

		TYPE N	SMA	TNC
Power	Cooling			
30 watts	Convection	ST422XX010	ST4222XX010	ST4221XX010
50 watts	Convection	ST422XX020	ST4222XX020	ST4221XX020
100 watts	Convection	ST422XX030	ST4222XX030	ST4221XX030
150 watts	Convection	ST422XX040	ST4222XX040	ST4221XX040

XXX / XX = Coef attenuation; coef = 3 dB => 003/03

## THERMAL CONDUCTIVITY COMPARISON

Synergy's improved design concept utilizes aluminum nitride in the resistive circuit. By employing this concept, s has improved the cooling capabilities of the coaxial attenuator's core. This provides better aging performance, increases the device's lifetime and robustness and enables Radiall to reduce the device's overall size for applications where form factor is an essential requirement. The reduced footprint, outstanding electrical performance and competitive pricing make Radiall's new high power attenuators the perfect solution for microwave applications.

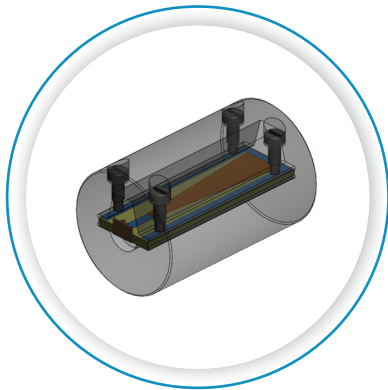

Attenuator Module

Synerg's new range of medium and high power attenuators increases possibilities for the defense, telecom and measurement markets.

AVERAGE POWER @25 °C (W)	30	50	100	150
Operating frequency (GHz)	DC - 6			
V.S.W.R.	1.25 up to 6 GHz			
Attenuation	3 / 6 / 10 / 20 / 30 dB			
Deviation (± dB)	0.5 / 0.75 / 0.75 / 1.5 / 2.2			
Impedance (Ω)	50			
DC resistance (Ω)	50 ± 5%			
Peak power @ 25 °C (1μs, 1%) (kW)	2			
Operating temperature range (°C)	-55 / +125			
Storage temperature range (°C)	-55 / +125			

#### FEATURES & BENEFITS

- Compatible with several types of connections
- Custom models available on demand
- Excellent electrical performances
- Competitive price
- Robust design

#### APPLICATIONS

- Military radar
- Test & Measurement of any telecom and military equipment
- Instrumentation radio frequency equipment