

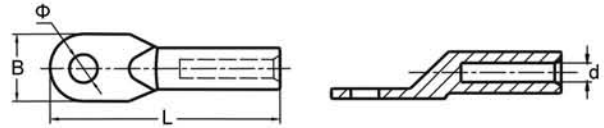

## ALUMINIUM LUG

**DL**



Material: Al-99.5%  
 Surface treatment: Bright  
 Products property: It is used to connect the aluminum conductor end.

Type	Dimensions(mm)			
	L	d	B	φ
DL16-6	70	5.8	16	6.5
DL16-8	70	5.8	16	8.5
DL25-8	75	7.2	17.5	8.5
DL35-8	85	8.5	20	8.5
DL35-10	85	8.5	20	10.5
DL50-10	90	9.7	23	10.5
DL70-12	100	11.5	26	12.5
DL95-12	110	13.5	28	12.5

Type	Dimensions(mm)			
	L	d	B	φ
DL120-14	120	15	31	14.5
DL150-14	125	16.5	35	14.5
DL150-16	125	16.5	35	17
DL185-16	133	18.5	37.5	17
DL240-16	140	21	40	17
DL300-18	160	23.5	44.5	18.5
DL300-20	160	23.5	44.5	21